

6314-2Z Deep groove ball bearings

- Popular item
- SKF Explorer

Deep groove ball bearings

Bearing data

[Tolerances](#),

Normal (metric), P6, P5, Normal (inch),

[Radial internal clearance](#),

Matched bearing pairs, Stainless steel
 $d < 10$ mm, Other bearings

Bearing interfaces

[Seat tolerances for standard conditions](#),

[Tolerances and resultant fits](#)

Technical specification

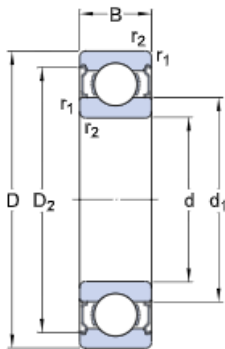

DIMENSIONS

d	70 mm	Bore diameter
D	150 mm	Outside diameter
B	35 mm	Width
d_1	≈ 94.95 mm	Shoulder diameter
D_2	≈ 129.9 mm	Recess diameter
$r_{1,2}$	min. 2.1 mm	Chamfer dimension

ABUTMENT DIMENSIONS

d_{ξ} min.	82 mm	Diameter of shaft abutment
d_{ξ} max.	94.9 mm	Diameter of shaft abutment
D_{η} max.	138 mm	Diameter of housing abutment
r_a max.	2 mm	Radius of shaft or housing fillet

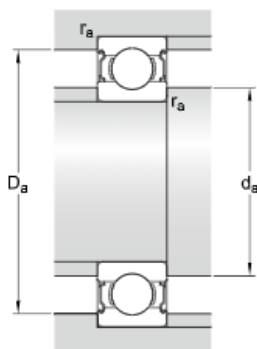

CALCULATION DATA

C	111 kN	Basic dynamic load rating
C ₀	68 kN	Basic static load rating
P _u	2.75 kN	Fatigue load limit
	9 500 r/min	Reference speed
	5 000 r/min	Limiting speed
k _r	0.03	Minimum load factor
f ₀	13.2	Calculation factor

MASS

	2.65 kg	Mass bearing
--	---------	--------------

TOLERANCE CLASS

P6	Dimensional tolerances
Normal	Radial run-out